

# Heavy Duty

## Types 25|30|50|66|80

TÜV/GS and DGUV Test-certified  
cable holders for

- Lighting fixtures
- Fair booth Construction
- Constructions sites
- Rigging



REUTLINGER<sup>®</sup>  
systematic suspension



# The world's only TÜV/GS-certified cable holders



**The TÜV/GS- and DGUV Test-Certificate**  
A safety guarantee from REUTLINGER.

## The only TÜV/GS-certified holders

The German TÜV is internationally renowned as a rigorous testing institution and is highly trusted by producers and consumers – especially for technical products.

The highest and most comprehensive level of TÜV testing is GS certification, denoting safe equipment and recognisable by the well-known blue sticker.

REUTLINGER is the world's only manufacturer of cable suspension systems that has succeeded in complying with the demands of GS certification with every product line: Our promise of safety confirmed by the TÜV\*.

**Certified by DGUV Test**  
Additionally holders Type 50 SV III, Type 66 SV III und Type 80 SV III are certified within the scope of standard DGUV Regulation 17 (BGV C1), also see page 16.



## TÜV/GS-Certification

The following REUTLINGER holders have been TÜV/GS-certified

### Holders Type 25

Certificate no.  
TÜV/GS Z1A 15 04 14229 047

### Holders Type 30

Certificate no.  
TÜV/GS Z1A 12 03 14229 040



## TÜV/GS- and DGUV Test-certification

The following holders have been certified by TÜV/GS und DGUV Test:

### Holders Type 50 SV III,

### Type 66 SV III and Type 80 SV III

Certificate no.  
TÜV/GS Z1A 16 06 14229 050  
DGUV Test OA 1651018

\* The German TÜV is a semi-governmental technical supervisory agency



**Loadable & Flexible**

Even when suspending heavy loads, REUTLINGER holders are infinitely adjustable up and down the cable without tools.

Unscrew safety cap, suppress plunger, slide the holder, release the plunger and screw down the safety cap – that’s it.

**REUTLINGER · Specialists for cable attachments and suspension 04**

**Technical Information, Certification**

TÜV/GS certification ..... 02  
 Mounting instruction, safety caps, working loads and cables ..... 05  
 DGUV Test certification for holders type 50 SV III, 66 SV III and 80 SV III .... 16

**Holder type 25 06**

Central cable exit, with external thread ..... 06  
 Lateral cable exit, with external or internal thread ..... 07  
 Central cable exit or lateral cable exit, with external or internal thread, safety cap and knurl ..... 08  
 Special versions with central cable exit, with oder without safety cap ..... 08

**Holder type 30 10**

Central cable exit, with external thread, safety cap and with or without knurl ..... 10  
 Lateral cable exit, with internal thread, safety cap and with or without knurl ..... 11  
 Special versions with central or lateral cable exit and safety cap ..... 12

**Holder type 30 [black zinc-plated] 14**

Central or lateral cable exit, with external or internal thread and safety cap, with or without knurl ..... 14  
 Special Versions, with safety cap ..... 15

**Holder type 50 SV III 17**

Central cable exit, with external thread and safety cap ..... 17

**Holder type 50 SV III [black zinc-plated] 18**

Central cable exit, with safety cap ..... 18  
 Lateral cable exit, with safety cap ..... 19

**Holder type 66 SV III [black zinc-plated] 20**

Central cable exit, with safety cap ..... 20  
 Lateral cable exit, with safety cap ..... 21

**Holder type 80 SV III [black zinc-plated] 22**

Central cable exit, with safety cap ..... 22  
 Lateral cable exit, with safety cap ..... 23

**Drahtseile, Zubehör 24**

Cables ..... 24  
 Cable terminations ..... 25  
 Ceiling attachments ..... 26  
 Tensioning systems ..... 27

**Contact 28**

## REUTLINGER - Specialists for cable attachments and suspension



### From a traditional workshop into a global high-tech company

„Technology should help us reach our goals. Therefore REUTLINGER constantly strives for logic and simplicity in all our products. Every detail must be functional and each function must make sense.“

For REUTLINGER this is not just a guiding principle, but an obligation. In the year 1864 W. B. Reutlinger began with the industrial manufacturing and processing of hemp rope and mechanical steel cable.

Wolf Reutlinger, who has led the company since 1987, continued this tradition of craftsmanship while initiating innovative processes which opened up new applications and markets.

### More than meets the eye

The use of REUTLINGER fastening attachments always results in permanent connections. This is the effect guaranteed by the self-locking mechanisms at the heart of our attachments. The elements devised specifically for this purpose are based on the following principle: the heavier the load – the greater the clamping force. For safe working loads (SWL) up to 480 kg.

By continually expanding the range of our products we were able to dominate the world market for suspended lighting fixtures within a few years. Today we are proud to count virtually all producers of high-quality lighting fixtures – as well as the automobile industry, sign- and shelf-manufacturers, galleries and museums – among our regular customers.

### Customer demands – a constant incentive to innovate

Highly qualified employees, the use of modern CAD systems and fully automated production facilities allow us to consistently turn out innovative products of unvarying high quality. We individually develop and manufacture our products in close cooperation with our customers. We put all our know-how at the disposal of our customers – from initial planning to detailed construction and manufacture right up to final installation.

### »Improve what is good, change what is ineffective«

Keeping an eye on quality and costs reflects this thinking – in all of our products. We pay special attention to the constant optimising of the following factors:

- increase loadability of the complete system
- reduce size to improve visual appeal
- increase design variations
- reduce customers' installation time

## Adjusting without tools

First, the knurled cap is unscrewed a few thread turns so the cable can be inserted (see illustration 1).

Once the holder is put in place, the cap is screwed down until firm resistance is felt. This pulls the cable into the cone (see illustration 2).

Vertical readjustment of the holder follows the same procedure (see illustration 3).

Inadvertent unclamping through skewed loading or inattentiveness can no longer result in fallen loads.

We recommend occasional readjustment of the safety cap.

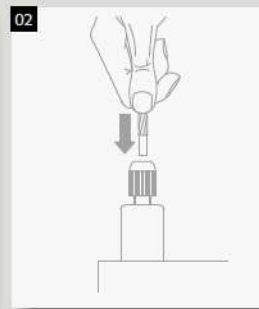
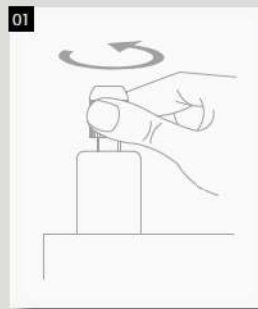

## Safety caps

Safety caps prevent inadvertent release of the clamping mechanism inside the holders. That's why the plunger is threaded. Safety caps are available in various versions.

- Cylindrical safety caps available with cross knurling (see p. 8) or vertical knurling (see p. 10)

- Domed safety caps are available with or without cross- oder vertical knurling

## Working loads & cables

A system's SWL equals 20% of its breaking load.

SWL is increased by 20% when using 6-ball holders.

Cables				Recommended cables & working loads														
ø [mm]	Material	Surface	Construction	fivefold safety [TÜV/GS]			tenfold safety [DGUV]											
				Type 25	Type 30	Type 30 S	Type 50 SV III		Type 66 SV III		Type 80 SV III							
							DGUV	TÜV	DGUV	TÜV	DGUV	TÜV						
1,5	Stainless Steel	Stainless steel	DIN EN 12385-4 7x7, 1.570 N/mm <sup>2</sup>	23 kg														
	Steel	zinc-plated silver	DIN EN 12385-4 7x7, 2.300 N/mm <sup>2</sup>	24 kg														
1,8	Stainless Steel	Stainless steel	DIN EN 12385-4 7x7, 1.570 N/mm <sup>2</sup>	30 kg														
	Steel	zinc-plated silver	DIN EN 12385-4 7x7, 2.300 N/mm <sup>2</sup>	42 kg														
2,0	Stainless Steel	Stainless steel	DIN EN 12385-4 7x7, 1.570 N/mm <sup>2</sup>	35 kg														
	Steel	zinc-plated silver	DIN EN 12385-4 7x7,	56 kg														
2,5	Stainless Steel	Stainless steel	DIN EN 12385-4 7x7, 1.570 N/mm <sup>2</sup>	42 kg	50 kg	60 kg												
	Steel	zinc-plated silver	DIN EN 12385-4 7x7, 2.300 N/mm <sup>2</sup>	68 kg	70 kg	84 kg												
3,0	Stainless Steel	Stainless steel	DIN EN 12385-4 7x7, 1.570 N/mm <sup>2</sup>		70 kg	84 kg												
	Steel	zinc-plated silver	DIN EN 12385-4 7x7, 2.300 N/mm <sup>2</sup>		85 kg	102 kg												
4,0	Steel	zinc-plated black/silver	6x7+1FE, 1.770 N/mm <sup>2</sup>				60 kg	120 kg										
	Steel	zinc-plated silver	6x19+1FE, 1.770 N/mm <sup>2</sup>				60 kg	120 kg										
5,0	Steel	zinc-plated black/silver	6x7+1FE, 1.770 N/mm <sup>2</sup>				90 kg	180 kg										
	Steel	zinc-plated silver	6x19+1FE, 1.770 N/mm <sup>2</sup>				90 kg	180 kg										
6,0	Steel	zinc-plated silver	6x19+1FE, 1.770 N/mm <sup>2</sup>						135 kg	270 kg	135 kg	270 kg						
	Steel	zinc-plated silver	6x37+1FE, 1.770 N/mm <sup>2</sup>						135 kg	270 kg	135 kg	270 kg						
	Steel	zinc-plated black	6x19+1SE, 1.960 N/mm <sup>2</sup>						135 kg	270 kg	135 kg	270 kg						
6,35 (1/4")	Steel	zinc-plated silver	6x19+1FE, 1.770 N/mm <sup>2</sup>						150 kg	300 kg								
	Steel	zinc-plated silver	6x19+1SE, 1.770 N/mm <sup>2</sup>						150 kg	300 kg								
8,0	Steel	zinc-plated silver	6x19+1FE, 1.770 N/mm <sup>2</sup>												240 kg	480 kg		
	Steel	zinc-plated silver	6x37+1FE, 1.770 N/mm <sup>2</sup>												240 kg	480 kg		
	Steel	zinc-plated black	6x19+1SE, 1.960 N/mm <sup>2</sup>												240 kg	480 kg		

Chart 1: Recommended cables & working loads

## Holder type 25

Cable diameter 1.5 mm to 2.5 mm (all illustrations in actual size)

Central cable exit,  
with external thread



**01**

**Holder type 25**  
**M13x10A**

Collar diameter	15 mm
Length	20 mm
Coupling Thread	M13x1
Thread depth	10 mm
Ser. no.	193.000.364

**Holder type 25**  
**M16x12A**

Collar diameter	18 mm
Length	18 mm
Coupling Thread	M16x1
Thread depth	12 mm
Ser. no.	193.000.252

### Information

Other versions on demand,  
e.g. with/without knurl,  
with/without safety cap



**02**

**Holder type 25**

Diameter	12 mm
Length	32 mm
Thread depth	6 mm
M8 Ser. no.	193.000.250
M10x1 Ser. no.	193.000.248



Ceiling Lamp, Model 'AIR' by NOSCH



Lateral cable exit,  
with external or internal thread



**01**  
Holder type 25 ZW

Diameter	12 mm
Length	44 mm
Coupling thread	M8/M10x1
Thread depth	7 mm
M8 Ser. no.	193.000.220
M10x1 Ser. no.	193.000.266



**02**  
Holder type 25 ZW

Diameter	12 mm
Length	44 mm
Coupling thread	M6i/M8i/M10x1i
Thread depth	8 mm
M6i Ser. no.	193.000.228
M8i Ser. no.	193.000.271
M10x1i Ser. no.	193.000.272



**03**  
Y-Holder type 25 ZW  
M6i cross hole 3 mm with  
set screw DIN 915 M6x8

Diameter	12 mm
Length	44 mm
Coupling thread	M6i
Thread depth	8 mm
Cross hole	3 mm
Ser. no.	193.000.765



## Holder type 25

Cable diameter 1.5 mm to 2.5 mm (all illustrations in actual size)

Central or lateral cable exit,  
with internal oder external thread,  
safety cap and knurl



**01**  
Holder type 25 V m.R.

Diameter	12 mm
Length	32 mm
Coupling thread	M8/M10x1
Thread depth	6 mm
M8 Ser. no.	193.000.241
M10x1 Ser. no.	193.000.251



**02**  
Holder type 25 V ZW m.R.

Diameter	12 mm
Length	44 mm
Coupling thread	M8/M10x1
Thread depth	7 mm
M8 Ser. no.	193.000.263
M10x1 Ser. no.	193.000.273



**03**  
Holder type 25 V ZW m.R.

Diameter	12 mm
Length	44 mm
Coupling thread	M6i/M8i/M10x1i
Thread depth	8 mm
M6i Ser. no.	193.000.242
M8i Ser. no.	193.000.274
M10x1i Ser. no.	193.000.275



**04**  
Y-Holder type 25 ZW  
M6i m.R. slot 3.0 mm and  
setscrew DIN 915 M6x8

Diameter	12 mm
Length	44 mm
Coupling thread	M6i
Thread depth	8 mm
slot width	3 mm
Ser. no.	193.000.288

Special versions  
with central cable exit,  
and safety cap



**05**  
Holder type 25 V  
M8, with fork 6x12

Diameter	12 mm
Length	56 mm
Usable fork depth	12 mm
Inside length fork	20 mm
Fork width	6 mm
Bolt diameter	6 mm
Ser. no.	193.000.034



Special versions  
with central cable exit and  
with oder without safety cap



**01**

**Holder type 25 V Ring**

Diameter	15 mm
Length	60 mm
External ring diameter	40 mm
Internal ring diameter	27,5 mm
Ser. no.	193.003.081



**02**

**Holder type 25 V  
M13x10A**

Collar diameter	15 mm
Length	20 mm
Coupling thread	M13x1
Thread depth	10 mm
Ser. no.	193.000.254

**Holder type 25 V  
M16x12A**

Collar diameter	15 mm
Length	20 mm
Coupling thread	M16x1
Thread depth	12 mm
Ser. no.	193.006.948



**03**

**Holder type 25 V K  
with coupling part M10x1 SW 14**

Diameter	12 mm
Length	26 mm
Coupling thread	M10x1
Wrench size	14 mm
Ser. no.	193.000.259



**04**

**Holder type 25  
Bo 6 (Gallery holder)**

Dimension	12x12 mm
Length	44,5 mm
Bore diameter	6,2 mm
Ser. no.	193.000.294

**Information**

Other versions upon request,  
e.g. with/without knurl,  
with/without safety cap



## Holder type 30\*

Cable diameter 2.5 mm to 3.0 mm (all illustrations in actual size)

30

### Higher safety through 6 clamping balls

In the »superholder« series, the clamping force is applied by 6 balls (Type SV) instead of 3 balls (Type V).

Their reinforced mechanism increases loadability by 20 %.



Special solutions for bevel suspensions: ball joint ceiling coupler at the ceiling and/or hinged holder at the object.

### Central cable exit, with external thread and safety cap



#### 01 Holder type 30 V M8

Diameter	15 mm
Length	37 mm
Connection thread	M8
Thread length	8 mm
Ser. no.	193.006.048

### Central cable exit, with external thread, knurl and safety cap



#### 02 Holder type 30 V/SV M8 m.R.

Diameter	15 mm
Length	37 mm
Coupling thread	M8
Thread depth	8 mm
Type V, 3 balls	Ser. no. 193.000.301
Type SV, 6 balls	Ser. no. 193.000.308

#### Holder type 30 V/SV M10 m.R.

as 01, except	
Coupling thread	M10
Thread depth	8 mm
Type V, 3 balls	Ser. no. 193.000.302
Type SV, 6 balls	Ser. no. 193.000.326

#### Information

Other versions upon request, e.g. with/without knurl, with/without safety cap



\* All holders type 30 are not certified by DGUV Test!



**01**  
Holder type 30 V/SV  
M10x1 m.R.

Diameter	15 mm
Length	37 mm
Coupling thread	M10x1
Thread depth	8 mm
Type V, 3 balls	Ser. no. 193.000.303
Type SV, 6 balls	Ser. no. 193.000.325

**Holder type 30 V/SV  
M12 m.R.**

Diameter	15 mm
Length	37 mm
Coupling thread	M12
Thread depth	8 mm
Type V, 3 balls	Ser. no. 193.000.300
Type SV, 6 balls	Ser. no. 193.000.305

**Holder type 30 V/SV  
M13x1 m.R.**

Collar diameter	15 mm
Length	37 mm
Coupling thread	M13x1
Thread depth	8 mm
Type V, 3 balls	Ser. no. 193.000.307
Type SV, 6 balls	Ser. no. 193.000.328



Lateral cable exit,  
with internal thread, knurl  
and safety cap



**02**  
Holder type 30 V/SV ZW  
M6i m.R.

Diameter	15 mm
Length	53 mm
Coupling thread	M6i
Thread depth	8 mm
Type V, 3 balls	Ser. no. 193.000.310
Type SV, 6 balls	Ser. no. 193.000.311

**Holder type 30 V/SV ZW  
M8i m.R.**

Diameter	15 mm
Length	53 mm
Coupling thread	M8i
Thread depth	8 mm
Type V, 3 balls	Ser. no. 193.000.315
Type SV, 6 balls	Ser. no. 193.000.330

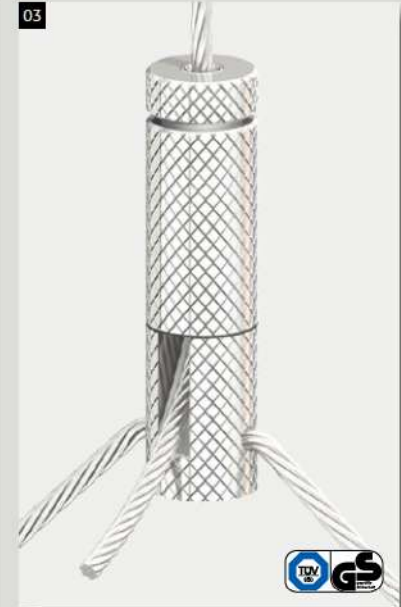

**03**  
Y-holder type 30 V/SV ZW m.R.  
with slot 3.0 mm and setscrew  
DIN 915 M6x8

Diameter	15 mm
Length	53 mm
Type V, 3 balls	Ser. no. 193.000.317
Type SV, 6 balls	Ser. no. 193.000.331

\* All holders type 30 are not certified by DGUV Test!

## Holder type 30\*

Cable diameter 2.5 mm to 3.0 mm (all illustrations in actual size)

30



»Sparkasse Burgelandkreis« Austria  
Chandelier made by SPECTRAL,  
Gesellschaft für Lichttechnik  
Photography by Thomas Dix

Special versions  
with central cable exit  
and safety cap

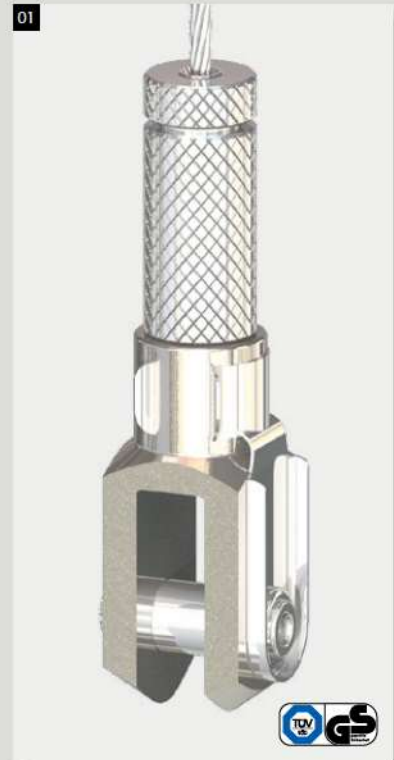

01  
Holder type 30 V/SV  
m.R. with fork 10x20 and  
safety bolt

Diameter	15 mm
Length	81 mm
Usable fork depth	20 mm
Inside length fork	32 mm
Fork width	10 mm
Bolt diameter	10 mm
Type V, 3 balls	Ser. no. 193.000.290
Type SV, 6 balls	Ser. no. 193.000.324

### Information

Other versions on demand,  
e.g. with/without knurl,  
with/without safety cap



\* All holders type 30 are not  
certified by DGUV Test!

Special versions  
with central or lateral cable exit  
and safety cap



**01**  
Holder type 30 V/SV  
Ring

Diameter	15 mm
Length	62 mm
External ring diameter	40 mm
Internal ring diameter	27.5 mm
Type V, 3 balls	Ser. no. 193.000.316
Type SV, 6 balls	Ser. no. 193.000.318



**02**  
Holder type 30 V/SV ZW  
m.R. hinged M8i

Diameter	15 mm
Length	80 mm
Coupling thread	M8i
Thread depth	10 mm
Type V, 3 balls	Ser. no. 193.000.347
Type SV, 6 balls	Ser. no. 193.000.346



**03**  
Holder type 30 V/SV  
Design Hook

Length	58 mm
Hooks opening	13 mm
Type V, 3 balls	Ser. no. 193.006.590
Type SV, 6 balls	Ser. no. 193.006.526

European utility patent  
000 169 594 - 0001+ 0002



\* All holders type 30 are not certified by DGUV Test!

# Holder type 30\*

Cable diameter 2.5 to 3.0 mm (all illustrations in actual size)

30

Central cable exit,  
with external thread  
and safety cap



**01**  
Holder type 30 SV  
M8, black zinc-plated

Diameter	15 mm
Length	37 mm
Coupling thread	M8
Thread length	8 mm
Type SV, 6 balls	Ser. no. 193.006.107

Central cable exit,  
with external thread, knurl  
and safety cap



**02**  
Holder type 30 SV  
M8 m.R., black zinc-plated

Diameter	15 mm
Length	37 mm
Coupling thread	M8
Thread length	8 mm
Type SV, 6 balls	Ser. no. 193.006.114

Alternative  
coupling threads:

M10	Ser. no. 193.006.113
M10x1	Ser. no. 193.006.268
M12	Ser. no. 193.006.112
M13x1	Ser. no. 193.006.111

Lateral cable exit with  
internal thread, knurl  
and safety cap



**03**  
Holder type Typ 30 SV ZW  
M6i m.R., black zinc-plated

Diameter	15 mm
Length	53 mm
Coupling thread	M6i
Thread depth	8 mm
Type SV, 6 balls	Ser. no. 193.006.110

Alternative coupling thread:

M8i	Ser. no. 193.006.109
-----	----------------------

### Information

Other versions on demand,  
e.g. with/without knurl,  
with/without safety cap



\* All holders type 30 are not certified by DGUV Test!

Special versions  
with safety cap



**01**  
Holder type 30 SV  
m.R. with fork 10x20 and  
safety-bolt, black zinc-plated

Diameter	15 mm
Length	81 mm
Usable fork depth	20 mm
Inside length fork	32 mm
Fork width	10 mm
Bolt diameter	10 mm
Type SV, 6 balls Ser. no. 193.006.267	



**02**  
Holder type 30 SV  
Ring, black zinc-plated

Diameter	15 mm
Length	62 mm
External ring diameter	40 mm
Internal ring diameter	27.5 mm
Type SV, 6 balls Ser. no. 193.006.293	



**03**  
Holder type 30 SV ZW  
m.R. hinged M8i,  
black zinc-plated

Diameter	15 mm
Length	80 mm
Coupling thread	M8i
Thread depth	10 mm
Type SV, 6 balls Ser. no. 193.006.108	



\* All holders type 30 are not certified by DGUV Test!

## Holder type 50 SV III, Type 66 SV III and Type 80 SV III with TÜV/GS and DGUV Test

Special holders for rigging  
and fair booth construction

### Type 50 SV III, 66 SV III and 80 SV III with TÜV/GS and DGUV Test



REUTLINGER® grippers type 50 SV III, type 66 SV III and type 80 SV III are not only certified as safe (GS) by the German TÜV, they have also been licensed for use within the scope of standard DGUV Regulation 17 (BGV C1).

The DGUV Test certificate authorises these grippers for use within the scope of the accident prevention regulations issued by the German employers' liability insurance associations in respect of staging and production facilities.

The test seal of the DGUV is conferred only after extensive examining of all load applications. Further testing simulated most anticipated mis-applications. REUTLINGER® gripper ranges 50 SV III, 66 SV III and 80 SV III are the only load-bearing devices certified by the DGUV for use in mobile production facilities.

More information be  
found in our Folder  
"Event Technology"!





Central cable exit  
with external thread  
and safety cap



**01**  
Holder type 50 SV III  
M12, nickel-plated

Diameter	25 mm
Length	51 mm
Coupling thread	M12
Thread length	18 mm
Ser. no.	393.006.898
DGUV certificate no.	OA 1651018

Central cable exit  
with safety cap



**02**  
Holder type 50 SV III  
Integral Ring, nickel-plated

Diameter	25 mm
Length	85 mm
External ring diameter	54 mm
Internal ring diameter	30 mm
Ser. no.	393.006.899
DGUV certificate no.	OA 1651018



**03**  
Holder type 50 SV III  
with fork 14x28 and safety bolt,  
nickel-plated

Diameter	25 mm
Length	107 mm
Usable fork depth	28 mm
Inside length fork	41 mm
Fork width	14 mm
Bolt diameter	14 mm
Ser. no.	393.006.901
DGUV certificate no.	OA 1651018



## Holder type 50 SV III

Cable diameter 4.0 to 5.0 mm (all illustrations are scaled)

Central cable exit  
with safety cap



**01**  
Holder type 50 SV III  
M12, black zinc-plated

Diameter	25 mm
Length	51 mm
Coupling thread	M12
Thread depth	18 mm
Ser. no.	393.005.021
DGUV certificate no.	OA 1651018

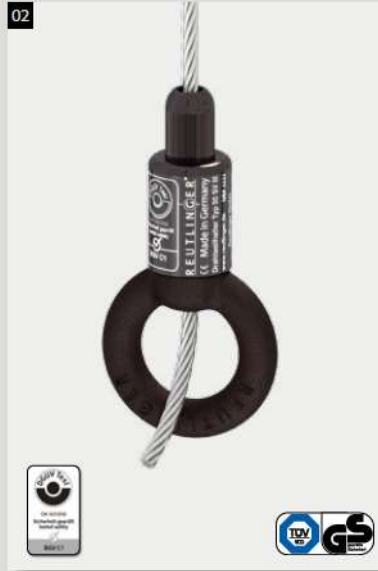

**02**  
Holder type 50 SV III  
Integral Ring, black zinc-plated

Diameter	25 mm
Length	85 mm
External ring diameter	54 mm
Internal ring diameter	30 mm
Ser. no.	393.005.033
DGUV certificate no.	OA 1651018



Holder type 50 SV III  
Integral Ring (actual size)

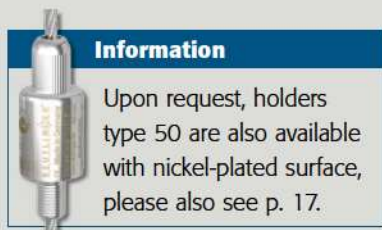

### Information

Upon request, holders type 50 are also available with nickel-plated surface, please also see p. 17.

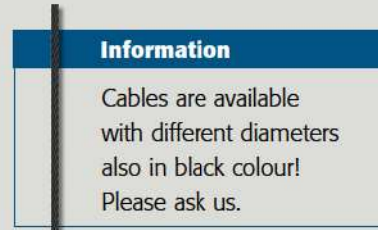

### Information

Cables are available with different diameters also in black colour! Please ask us.

Lateral cable exit  
with safety cap



**01**

**Holder type 50 SV III ZW  
M12i, black zinc-plated**

Diameter	25 mm
Length	72,5 mm
Coupling thread	M12i
Thread depth	10 mm
Ser. no.	393.005.025
DGUV certificate no.	OA 1651018

**02**

**Holder type 50 SV III ZW  
Ring, black zinc-plated**

Diameter	25 mm
Length	125 mm
External ring diameter	54 mm
Internal ring diameter	30 mm
Ser. no.	393.005.026
DGUV certificate no.	OA 1651018

**03**

**Holder type 50 SV III ZW  
with fork 14x28 and safety-bolt,  
black zinc-plated**

Diameter	25 mm
Length	145 mm
Usable fork depth	28 mm
Inside length fork	41 mm
Fork width	14 mm
Bolt diameter	14 mm
Ser. no.	393.005.027
DGUV certificate no.	OA 1651018

**04**

**Holder type 50 SV III ZW  
with Doughty® Coupler T58081,  
black zinc-plated**

Diameter	25 mm
Length	130 mm
For tube diameter	45 - 50 mm
Ser. no.	393.005.040
DGUV certificate no.	OA 1651018

## Holder type 66 SV III

Cable diameter 6.0 mm and 1/4" cables (all illustrations are scaled)

Central cable exit  
with safety cap



**01**

**Holder type 66 SV III**  
**M16, black zinc-plated**

Diameter	34 mm
Length	68 mm
Coupling thread	M16
Thread length	20 mm
Ser. no.	393.007.700
DGUV certificate no.	OA 1651018

**02**

**Holder type 66 SV III**  
**Integral Ring, black zinc-plated**

Diameter	34 mm
Length	110 mm
External ring diameter	63 mm
Internal ring diameter	35 mm
Ser. no.	393.007.701
DGUV certificate no.	OA 1651018



Holder type 66 SV III Integral Ring  
(actual size)



**Information**

Holders type 66 SV III are also available with nickel-plated surface (from 500 pcs). Delivery time upon request.

**Information**

Cables are available with different diameters also in black colour! Please ask us.

Lateral cable exit  
with safety cap



01

**Holder type 66 SV III ZW  
M16i, black zinc-plated**

Diameter	34 mm
Length	96 mm
Coupling thread	M16i
Thread depth	12 mm
Ser. no.	393.007.702
DGUV certificate no.	OA 1651018

02

**Holder type 66 SV III ZW  
Ring, black zinc-plated**

Diameter	34 mm
Length	160 mm
External ring diameter	63 mm
Internal ring diameter	35 mm
Ser. no.	393.007.709
DGUV certificate no.	OA 1651018

03

**Holder type 66 SV III ZW  
with fork 16x32 and safety-bolt,  
black zinc-plated**

Diameter	34 mm
Length	176 mm
Usable fork depth	32 mm
Inside length fork	51 mm
Fork width	16 mm
Bolt diameter	16 mm
Ser. no.	393.007.705
DGUV certificate no.	OA 1651018

04

**Holder type 66 SV III ZW  
with DOUGHTY® Coupler T58101,  
black zinc-plated**

Diameter	34 mm
Length	160 mm
For tube diameter	48 - 51 mm
Ser. no.	393.007.704
DGUV certificate no.	OA 1651018

## Holder type 80 SV III

Cable diameter 6.0 mm to 8.0 mm (all illustrations scaled)

Central cable exit  
with safety cap



**01**  
Holder type 80 SV III  
M20, black zinc-plated

Diameter	40 mm
Length	88 mm
Coupling thread	M20
Thread length	29 mm
Ser. no.	393.009.003
DGUV certificate no.	OA 1651018



**02**  
Holder type 80 SV III  
Integral Ring, black zinc-plated

Diameter	40 mm
Length	128 mm
External ring diameter	72 mm
Internal ring diameter	40 mm
Ser. no.	393.009.011
DGUV certificate no.	OA 1651018



Holder type 80 SV III  
Integral Ring (actual size)



**Information**



Holders type 80 SV III are also available with nickel-plated surface (from 500 pcs). Delivery time upon request.

**Information**

Cables are available with different diameters also in black colour! Please ask us.

Lateral cable exit  
with safety cap



**01**  
Holder type 80 SV III ZW  
M12i, black zinc-plated

Diameter	40 mm
Length	110 mm
Coupling thread	M12i
Thread depth	20 mm
Ser. no.	393.009.008
DGUV certificate no.	OA 1651018

**02**  
Holder type 80 SV III ZW  
Ring, black zinc-plated

Diameter	40 mm
Length	181 mm
External ring diameter	72 mm
Internal ring diameter	40 mm
Ser. no.	393.009.015
DGUV certificate no.	OA 1651018

**03**  
Holder type 80 SV III ZW  
with fork 20x40 and safety-bolt,  
black zinc-plated

Diameter	40 mm
Length	215 mm
Usable fork depth	40 mm
Inside length fork	65 mm
Fork width	20 mm
Bolt diameter	20 mm
Ser. no.	393.009.023
DGUV certificate no.	OA 1651018

**04**  
Holder type 80 SV III ZW  
with DOUGHTY® Coupler T57010,  
black zinc-plated

Diameter	40 mm
Length	195 mm
For tube diameter	48 - 50 mm
Ser. no.	393.009.009
DGUV certificate no.	OA 1651018

# Cables

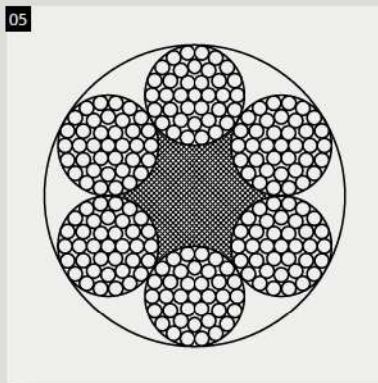
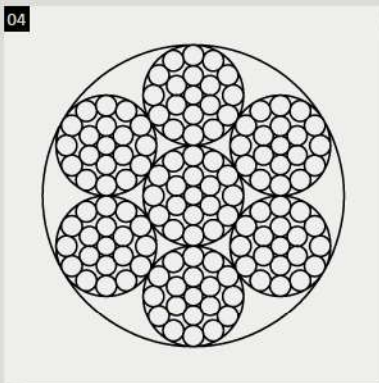
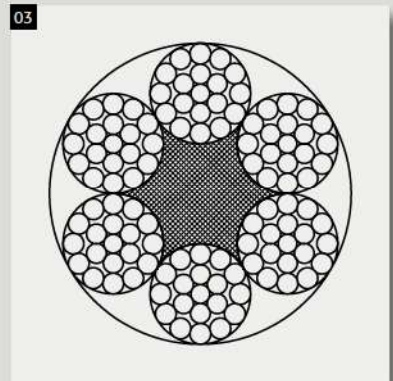
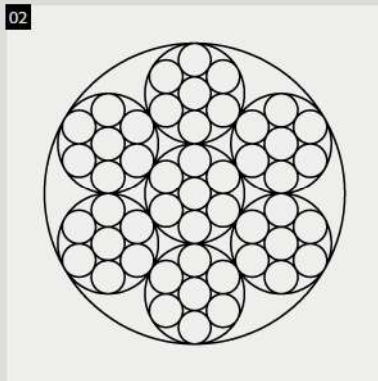
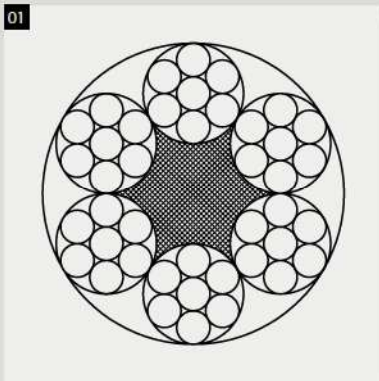

- 01 DIN EN 12385-4 6x7+1FE
- 02 DIN EN 12385-4 6x7+1SE
- 03 DIN EN 12385-4 6x19+1FE
- 04 DIN EN 12385-4 6x19+1SE
- 05 DIN EN 12385-4 6x37+1FE

**Please note:**

Cables must not be greased or oiled!

**1. Materials + surfaces**

Cables are available in two degrees of durability

- 1.1 galvanised steel for normal internal use
- 1.2 stainless steel for external use and decorative requirements

**2. Specific cable strength**

Along with the standard-strength cables with 1570 N/mm<sup>2</sup>, we also offer high-tensile strength cables with up to 2300 N/mm<sup>2</sup>. With these you get a higher system strength with the same cable diameter.

**3. Cable constructions**

You can choose between different cable constructions. Please note:

- 3.1 cables with steel core have a higher strength than those with a fibre core but they are less flexible.
- 3.2 Cables with many wires such as 6x37 are more flexible than cables with less wires, as in 7x7 cables.
- 3.3. Swaged-on threaded bolts require cables with steel cores.
- 3.4. Cables running on pulleys should have fibre cores.

**4. Cable diameter**

REUTLINGER offers holders suitable for cables from 1.5 mm to 8.0 mm diameter.

**5. Using other cables**

REUTLINGER cables are free of tension, stress-free, not twisted and cut-proof. When using other cables, take care that cutting does not untwist the cable, because it is possible that they will not fit into the holder after they have been tinned.

**6. Customised solutions**

Let us help you choose the best solution among our variety of cable ends.



## Cable terminations

Upon request cables with various cable ends custom-made to fit individual suspensions (length; materials; diameter).



01	02	03	04	05	06
<b>Loop</b>	<b>Loop &amp; Thimble</b>	<b>Threaded End</b>	<b>Forged Eyelet</b>	<b>Cylindrical sleeve</b>	<b>Zinc-plated ends</b>
Cables available see chart Dimensions according to drawing	Cables available see chart Dimensions according to drawing	Cables available see chart Dimensions according to drawing	Cables available see chart for bolt- $\varnothing$ up to 8 mm	Cables available see chart sleeve- $\varnothing$ 8,6 mm, sleeve length 11 mm	Cable ends zinc-plated, Cables available see chart

Cables				Cable ends					
$\varnothing$ [mm]	Material	Surface	Construction	01	02	03	04	05	06
1,5	Stainless steel	Stainless steel	DIN EN 12385-4 7x7, 1.570 N/mm <sup>2</sup>	●	●	●	●	●	●
	Steel	Silver zinc-plated	DIN EN 12385-4 7x7, 2.300 N/mm <sup>2</sup>	●	●	●	●	●	●
1,8	Stainless steel	Stainless steel	DIN EN 12385-4 7x7, 1.570 N/mm <sup>2</sup>	●	●	●	●	●	●
	Steel	Silver zinc-plated	DIN EN 12385-4 7x7, 2.300 N/mm <sup>2</sup>	●	●	●	●	●	●
2,0	Stainless steel	Stainless steel	DIN EN 12385-4 7x7, 1.570 N/mm <sup>2</sup>	●	●	●	●	●	●
	Steel	Silver zinc-plated	DIN EN 12385-4 7x7, 2.300 N/mm <sup>2</sup>	●	●	●	●	●	●
2,5	Stainless steel	Stainless steel	DIN EN 12385-4 7x7, 1.570 N/mm <sup>2</sup>	●	●	●	●	●	●
	Steel	Silver zinc-plated	DIN EN 12385-4 7x7, 2.300 N/mm <sup>2</sup>	●	●	●	●	●	●
3,0	Stainless steel	Stainless steel	DIN EN 12385-4 7x7, 1.570 N/mm <sup>2</sup>	●	●	●	●	●	●
	Steel	Silver zinc-plated	DIN EN 12385-4 7x7, 2.300 N/mm <sup>2</sup>	●	●	●	●	●	●
4,0	Steel	Silver/black zinc-plated	6x7+1FE, 1.770 N/mm <sup>2</sup>	●	○	●	●	●	○
	Steel	Silver zinc-plated	6x19+1FE, 1.770 N/mm <sup>2</sup>	●	○	●	●	●	○
5,0	Steel	Silver/black zinc-plated	6x7+1FE, 1.770 N/mm <sup>2</sup>	●	○	●	●	●	○
	Steel	Silver zinc-plated	6x19+1FE, 1.770 N/mm <sup>2</sup>	●	○	●	●	●	○
6,0	Steel	Silver zinc-plated	6x19+1FE, 1.770 N/mm <sup>2</sup>	●	○	●	●	●	○
	Steel	Silver zinc-plated	6x37+1FE, 1.770 N/mm <sup>2</sup>	●	○	●	●	●	○
	Steel	Black zinc-plated	6x19+1SE, 1.960 N/mm <sup>2</sup>	●	○	●	●	●	○
6,35 (1/4")	Steel	Silver zinc-plated	6x19+1FE, 1.770 N/mm <sup>2</sup>	●	○	●	●	●	○
	Steel	Silver zinc-plated	6x19+1SE, 1.770 N/mm <sup>2</sup>	●	○	●	●	●	○
8,0	Steel	Silver zinc-plated	6x19+1FE, 1.770 N/mm <sup>2</sup>	●	○	●	●	●	○
	Steel	Silver zinc-plated	6x37+1FE, 1.770 N/mm <sup>2</sup>	●	○	●	●	●	○
	Steel	Black zinc-plated	6x19+1SE, 1.960 N/mm <sup>2</sup>	●	○	●	●	●	○

Chart 2: Cables with cable ends ● available; ○ only these swaged fittings and cable ends are permitted for use within the scope of DGUV Test! ● upon request

## Ceiling attachments [for cable diameter 1.5 to 3.0 mm]

### Ceiling attachments

Combine ceiling attachments and screw caps for a loadable ceiling suspension.

Various solutions upon request.



**01**  
Ceiling attachment  
M13x1 M6i

Flange diameter	20 mm
Diameter	16 mm
Length	21 mm
Coupling thread	M13x1
Ser. no.	029.006.003



**02**  
Screw-cap M13x1  
with bore 3,5 mm, SW 14

Flange diameter	16 mm
Diameter	12 mm
Thread depth	10 mm
Coupling thread	M13x1
Ser. no.	029.006.016

**Screw-cap M13x1  
with bore 2,4 mm SW 14**

Flange diameter	16 mm
Diameter	12 mm
Thread depth	10 mm
Coupling thread	M13x1
Ser. no.	029.006.002



**03**  
Screw-cap M13x1 ›Quick‹  
with slit 2,4 mm, SW 14

Flange diameter	16 mm
Diameter	12 mm
Thread depth	10 mm
Coupling thread	M13x1
Ser. no.	029.006.055



**01**  
Combination of  
Ceiling attachment M13x1 M6i  
and screw-cap M13x1 with  
bore 3,5 mm

Length	22 mm
Ser. no.	193.005.206

For details and further dimensions  
please see article **01** and **02** !

**Tensioning systems**

Tensioners allow you to create strong tensioning systems or vertical installations between floor and ceiling, for example. Tensioning solutions are ideal for the suspensions of displays and other elements. Further solutions upon request.



**01**  
**Tensioner type 25 V ZW**  
**with left-hand/right-hand thread**

Applicable with cables  $\varnothing$  1.5 mm to 2.5 mm  
 Collar diameter 16 mm  
 Diameter 12 mm  
 Width across flats 12 mm  
 Length (screwed) 46 mm  
 Ser. no. 193.006.002



**02**  
**Tensioner type 30 SV**  
**with big fastening plate**

Applicable with cables  $\varnothing$  2.5 mm to 3.0 mm  
 Attachment plate diameter 40 mm  
 Diameter 15 mm  
 Length (screwed) 77 mm  
 Ser. no. 193.000.352

**Information**  
 Tensioning systems using article **01** or **02** can be implemented with two tensioners each (top/bottom) or with a ceiling attachment, e.g. article **04** presented on page 26 (please see the image above).

